

ANNEXURE "H"
AFFIDAVIT OF MAROUN ANTOINE DRAYBI – 18 November 2021

COURT DETAILS

Court	Land and Environment Court of New South Wales
Division	Class 1
Registry	Land and Environment Court
Case number	2021/00168725

TITLE OF PROCEEDINGS

Applicant	A & A Development Pty Limited ACN 074 089 240
Respondent	Cumberland City Council

CERTIFICATE IDENTIFYING EXHIBIT

This and the following 9 pages is the annexure marked "H" referred to in the affidavit of Maroun Antoine Draybi sworn before me on 18 November 2021.

Signature of witness

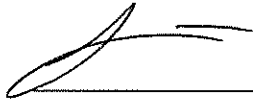

Name of witness

John Micheal Boustany

Address of witness

20 Fennell Street, Parramatta NSW 2150

Capacity of witness

Solicitor

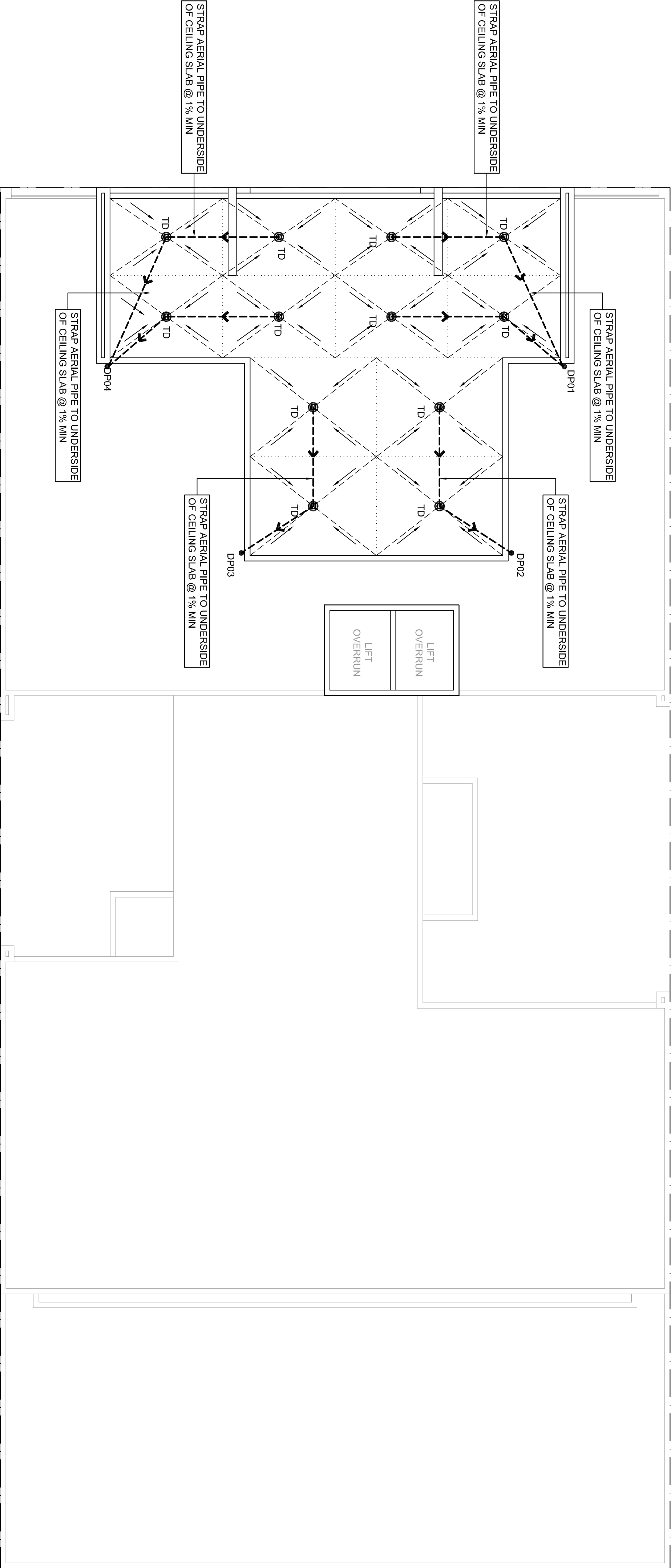

ROOF LAYOUT
1:100



wehbe CONSULTING

STORMWATER & STRUCTURAL ENGINEERS	
PO BOX 166, GATLANDS NSW 2117	JOB NUMBER: SW566
PHONE: 0425 290 099	DRAWING NUMBER: SW566-2
EMAIL: wehbe@optusnet.com.au	
PROJECT: PROPOSED DEVELOPMENT	
22-24 PARK ROAD, AUBURN	
DRAWINGS: ROOF LAYOUT	
DESIGNED: S.W.	SIGNED: S.WEHBIE BE MIE AUST CP ENG NPER3
DRAWN: A.L.	
DRAWINGS NOT TO BE USED FOR CONSTRUCTION UNLESS SIGNED BY DESIGNING ENGINEER	
ISSUE	APPROX DATE
E	13.02.19
ISSUED FOR DA	
REVISION DESCRIPTION	

SITE AREA	= 1226 m ²
MINIMUM STORAGE	= 325 MWh ³
MAXIMUM DISCHARGE	= 150 l/s/ha
REQUIRED STORAGE	= 39.85 m ³
PERMITTED DISCHARGE	= 18.39 l/s

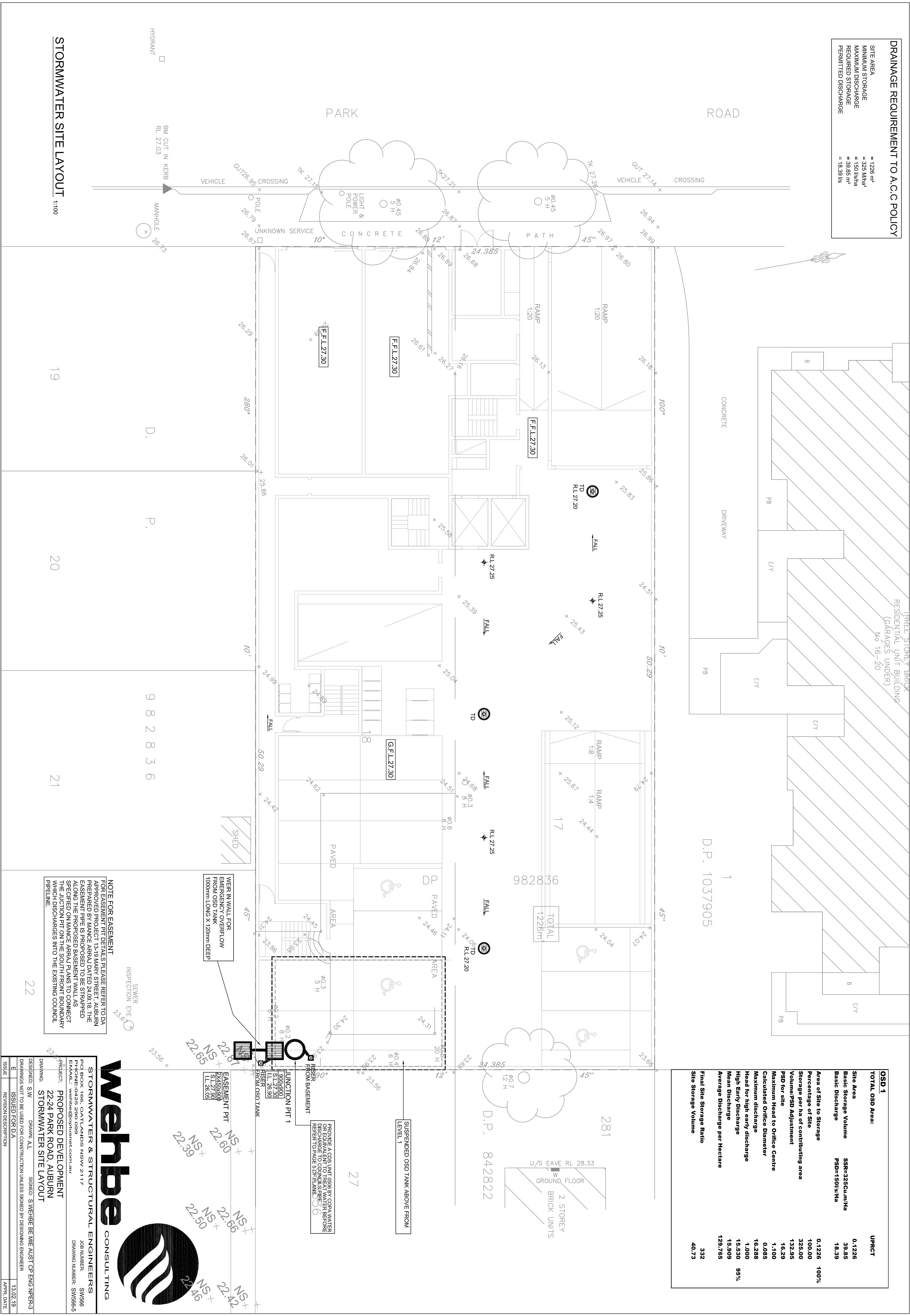

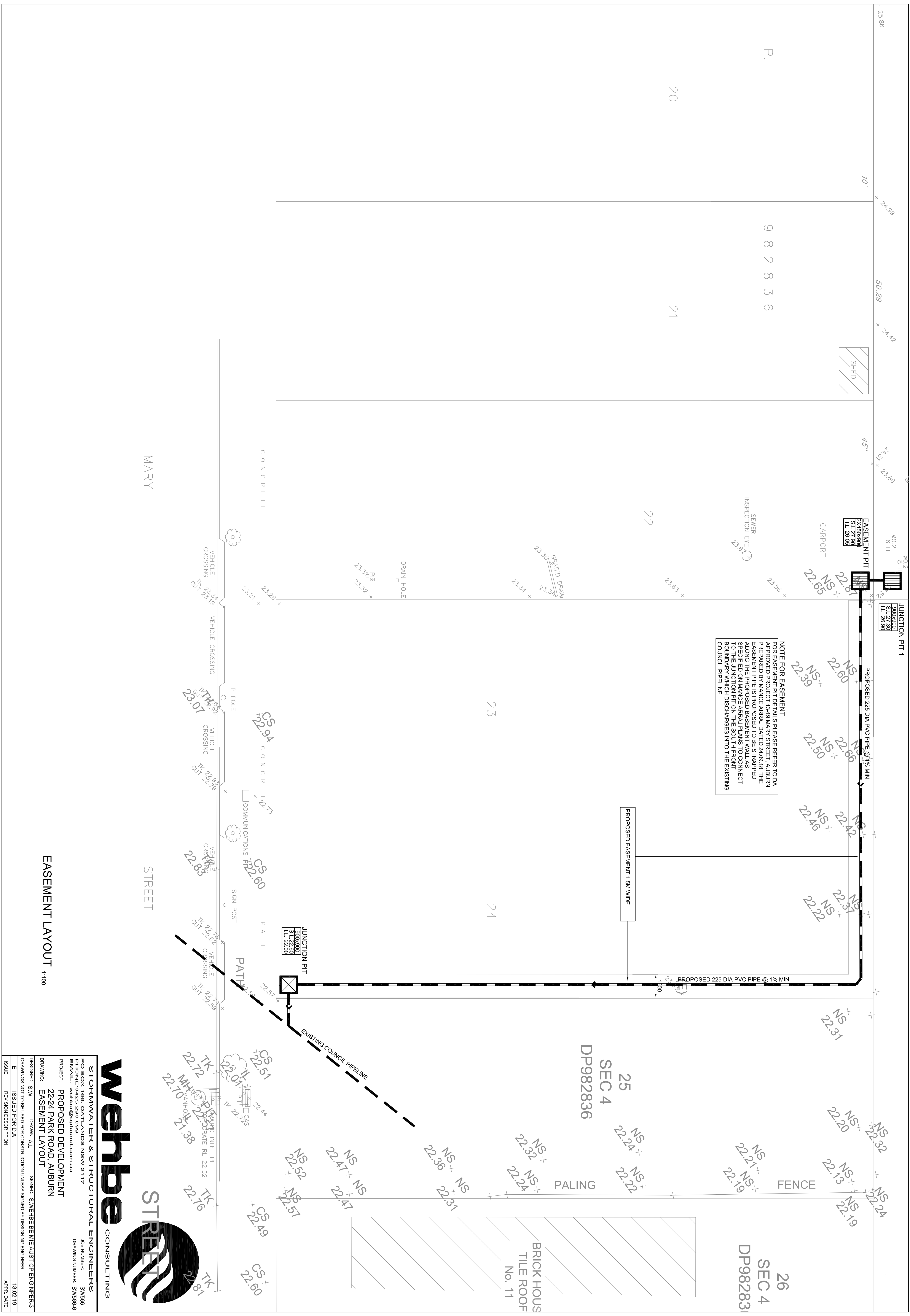

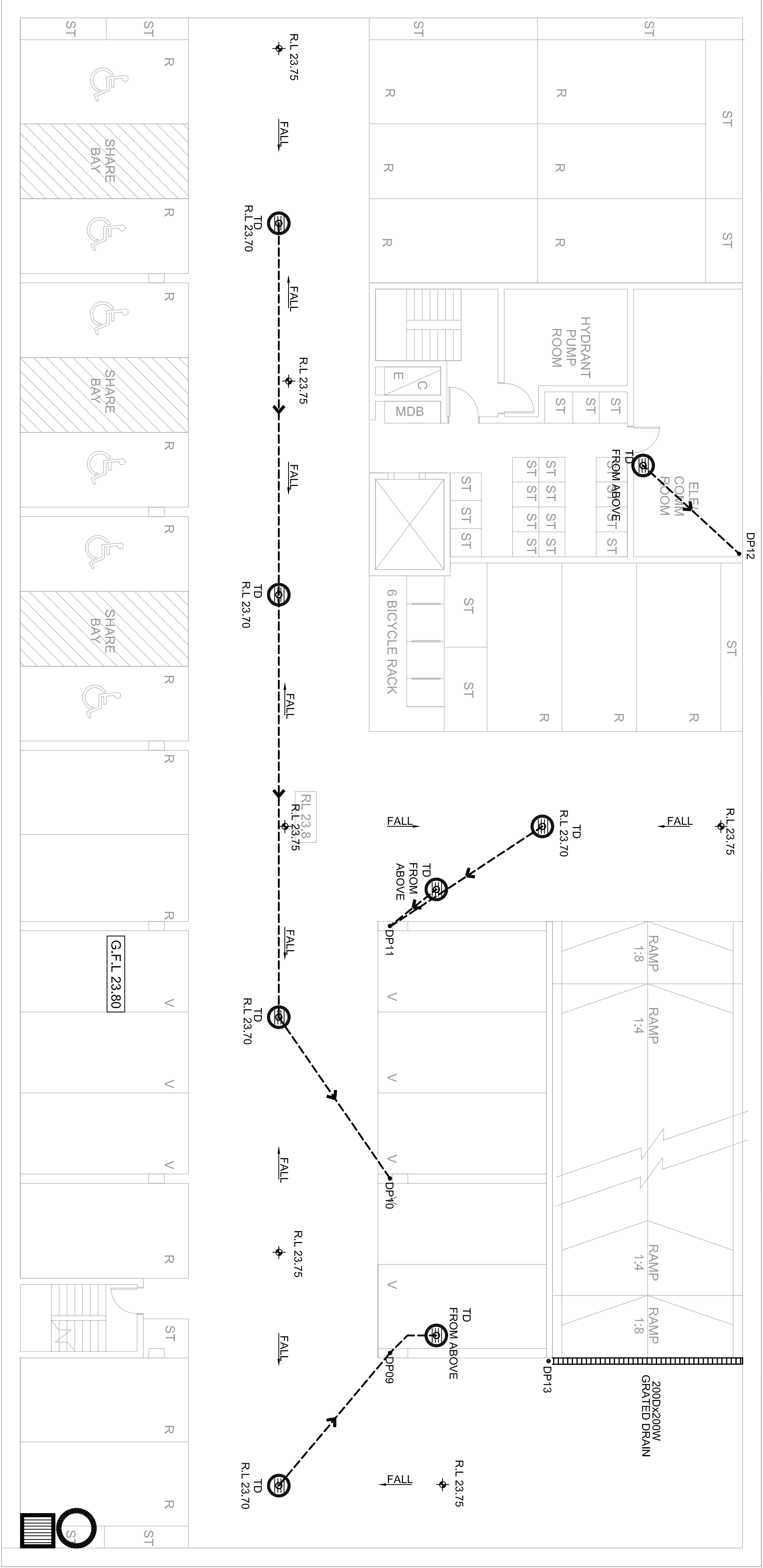

BASEMENT 1 LAYOUT 1:100

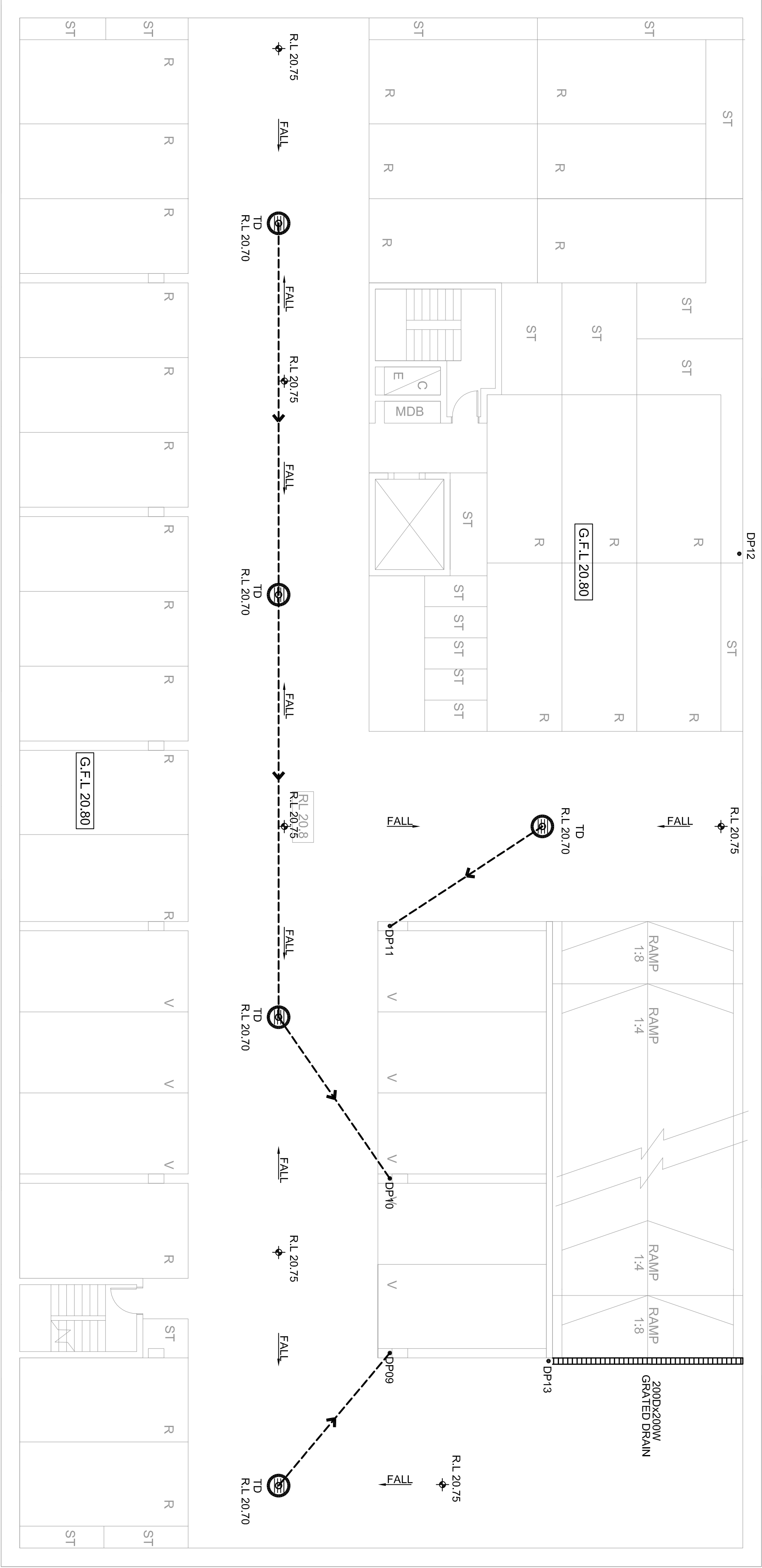

BASEMENT 2 LAYOUT 1:100

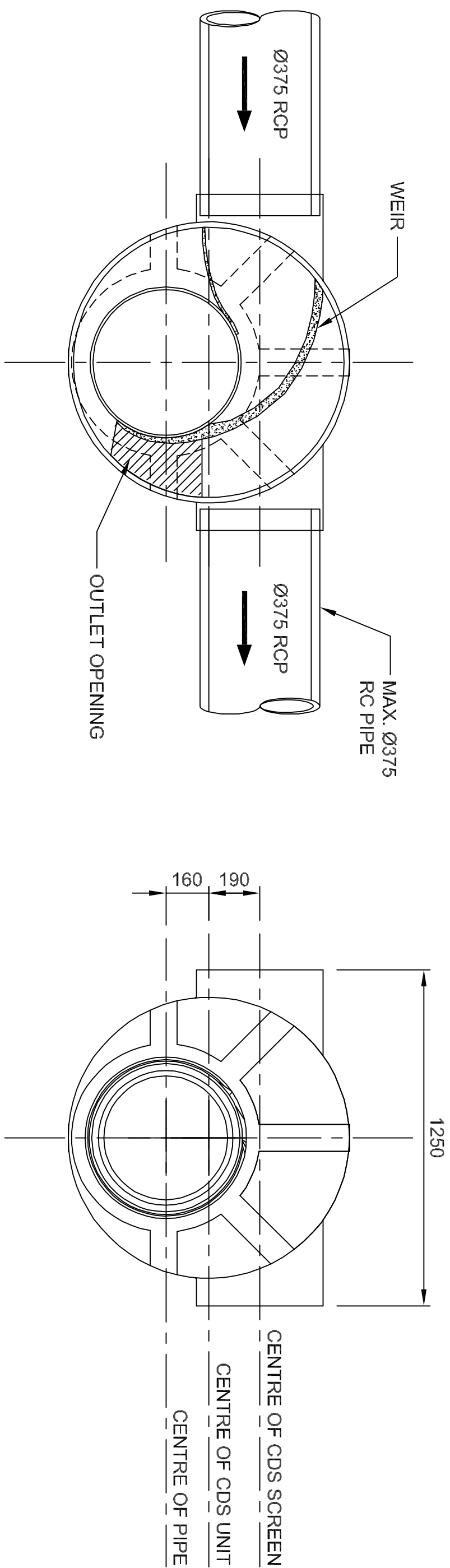

PLAN

TOP VIEW

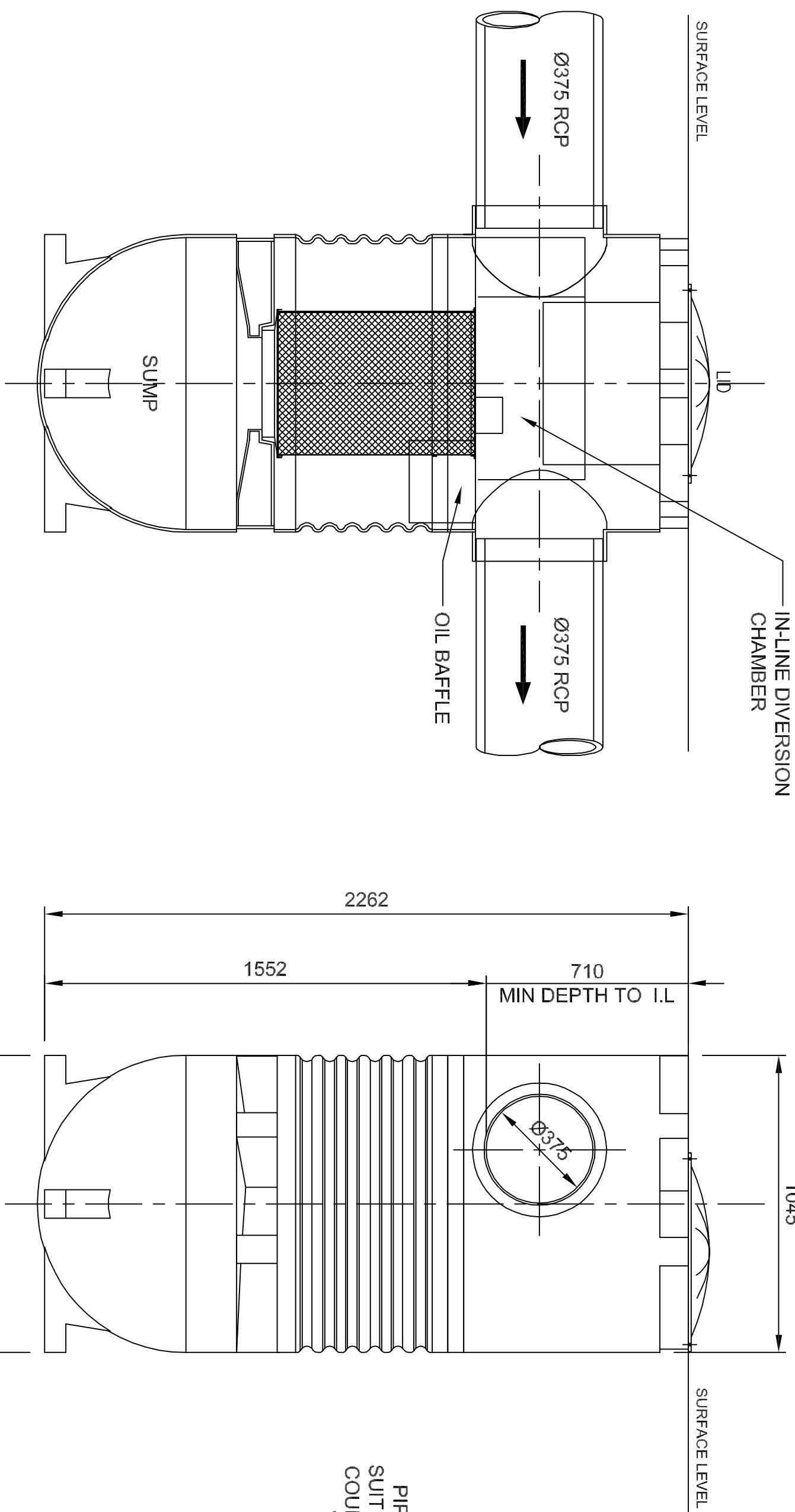

SECTION

END VIEW

PIPE FITTINGS AS SHOWN FEMALE TO SUIT RC PIPE. 385mm MAX OUTSIDE DIA. COULD ALSO BE CUT OUT TO INSIDE OF WALL THICKNESS TO SUIT RC PIPE. 445mm MAX OUTSIDE DIA.

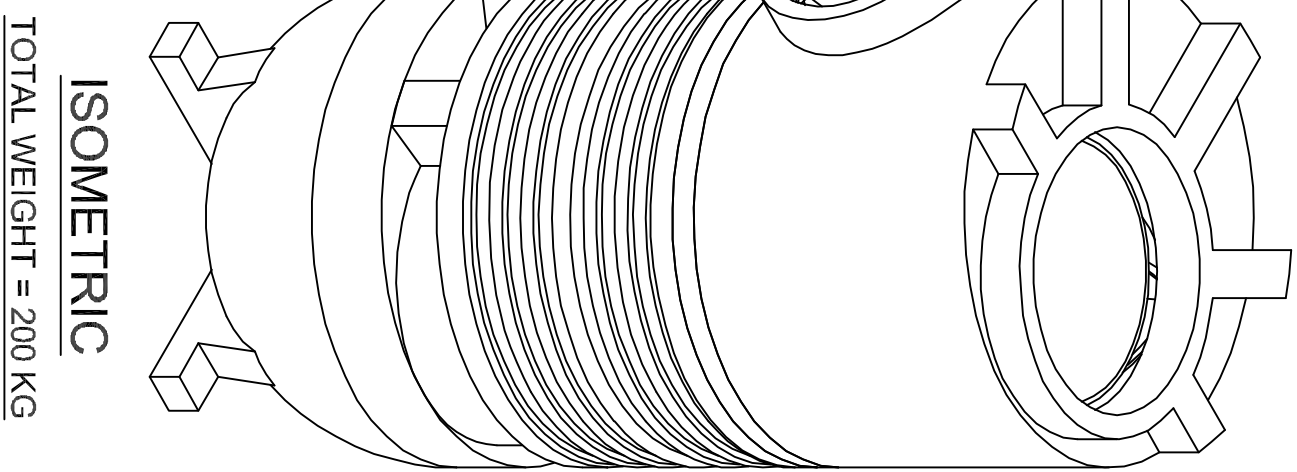

ISOMETRIC
TOTAL WEIGHT = 200 KG

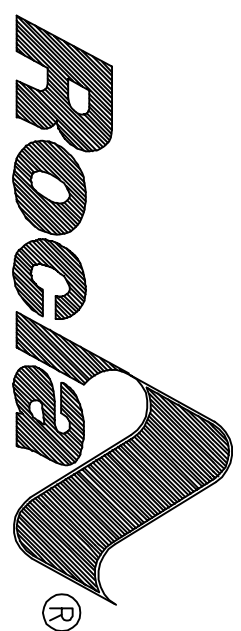

CDSP0506 GPT GENERAL ARRANGEMENT N.T.S



STORMWATER & STRUCTURAL ENGINEERS		
PO BOX 166, CANTLANDS NSW 2117		
PHONE: 0425 290 099		
EMAIL: wehbe@optusnet.com.au		
JOB NUMBER: SW566		
DRAWING NUMBER: SW566-9		
PROJECT: PROPOSED DEVELOPMENT		
22-24 PARK ROAD, AUBURN		
DRAWING: CDS UNIT DETAILS		
DESIGNED: S.W.		
DRAWN: A.L.		
SIGNED: S. WEHBE BE MIE AUSTRALIAN ENGINEER		
DRAWINGS NOT TO BE USED FOR CONSTRUCTION UNLESS SIGNED BY DESIGNING ENGINEER		
ISSUE	REVISION DESCRIPTION	APPROX. DATE
E	ISSUED FOR D.A.	13.02.19